

07-7-36-4

DRAWING NUMBER

DRAWING NUMBER

DRAWING NUMBER

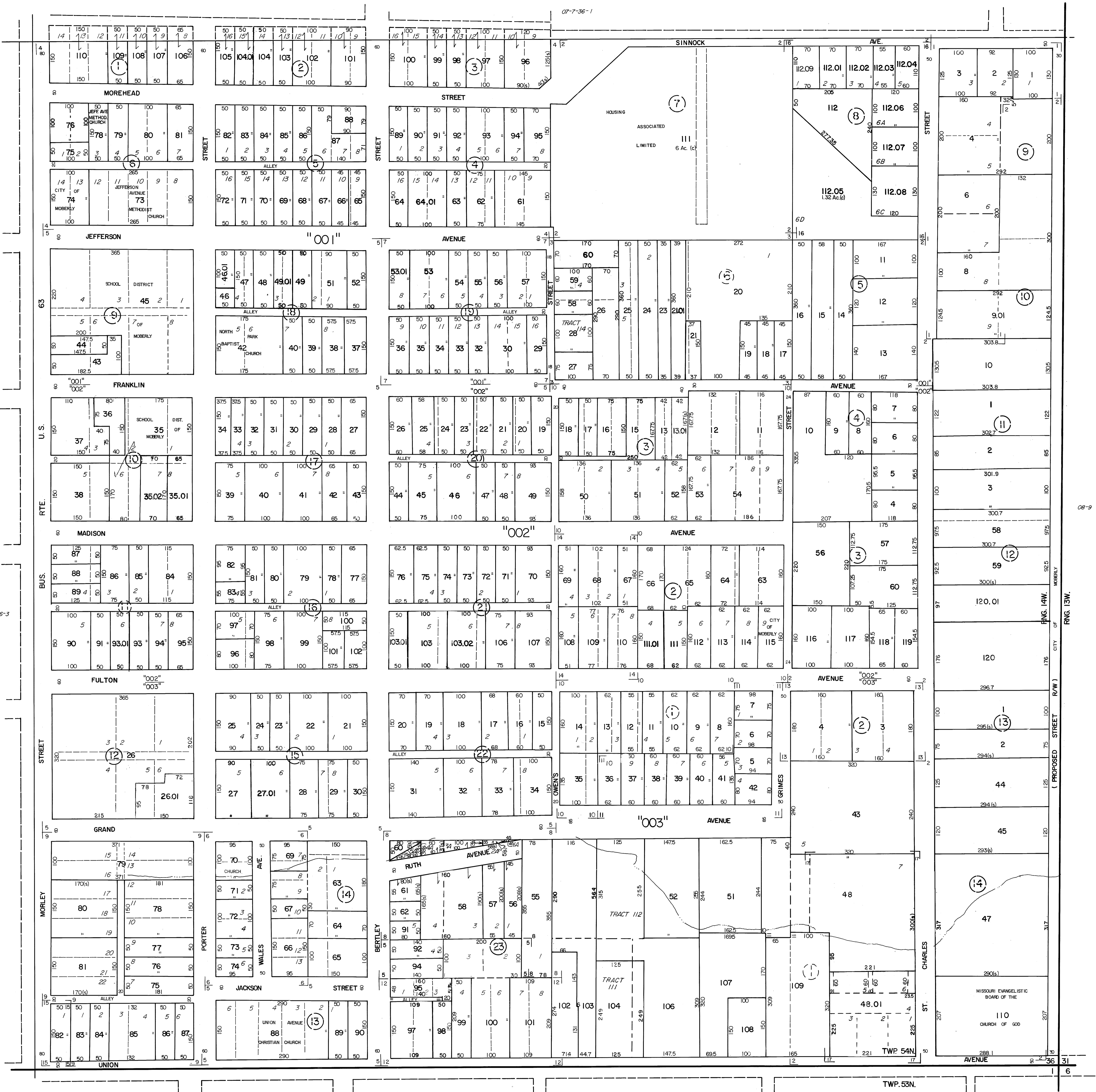

07-7-36-3

07-7-36-1

08-9

RNG. 13W.

RNG. 14W.

RNG. 15W.

**OWNERSHIP MAP**  
**RANDOLPH COUNTY, MISSOURI**  
 PREPARED UNDER THE DIRECTION OF  
**STATE TAX COMMISSION OF MISSOURI**  
 AND  
**RANDOLPH COUNTY TAX ASSESSOR**  
 PREPARED BY  
**ROBINSON AND ASSOCIATES, INC.**  
 306 OAK AVE., SPRUCE PINE, N.C. 28777

SCALE: 1" = 100'  
 DATE OF MAP: APRIL 23, 1981  
 DATE OF PHOTOGRAPHY: NOV. 1980  
 AERIAL PHOTO NO. SE. 36-54-14

**SUBDIVISION INDEX**

SUBD. NO.	SUBDIVISION NAME	PLAT BOOK	PAGE
1	GILBERT'S SUB-DIVISION	B-V 3	88
2	GRIME'S ADDITION	B-V 3	17
3	NEWTON'S SUB-DIVISION OF GRIMES	B-V 182	1
4	GOATS & CHANDLER'S 1ST ADDITION	B-V 3	98
5	BURKHOLDER'S 1ST ADDITION	B-V 182	168
6	WALLES'S SUB-DIVISION	B-V 182	168
7	NEWTON & KRIBBS SUB-DIVISION OF BURKHOLDER'S 1ST	B-V 182	87
8	HANNAH'S SUB-DIVISION OF BURKHOLDER'S 1ST	B-V 182	87
9	WASH GRIME'S ADDITION	B-V 182	6
10	OWENS'S ADDITION	B-V 182	66
11	RIEDEL'S SUB-DIVISION	B-V 182	16, 816
12	GRIMES'S ADDITION	B-V 182	6
13	BEASMAN'S SUB-DIVISION BLK 2 GRIME'S ADDITION	B-V 182	6
14	W. A. HOWELL'S SUB-DIVISION	DB 178	382
15	UNION AVENUE SUB-DIVISION	B-V 2	6
16	VANDERBECK'S SUB-DIVISION BLK 6 GRIME'S ADDITION	B-V 6	14

**LEGEND**

STATE LINE	---	AREA (FROM DEED)	10.5Ac.
COUNTY LINE	---	AREA (CALCULATED)	10.5Ac.(c)
CORPORATION LINE	---	DIMENSION (FROM DEED)	16.5
DISTRICT LINE	---	DIMENSION (CALCULATED)	66'(s)
ROAD R/W	---	SUBDIVISION LOT NUMBER	23
TOWNSHIP & RANGE LINES	---	PARCEL NUMBER	45
RAILROAD R/W	---	WATER	---
PROPERTY LINE	---	INTERSTATE HIGHWAY	---
LAND HOOK	---	U.S. HIGHWAY	---
SECTION LINE	---	STATE HIGHWAY	---
INTERIOR OR ORIGINAL TRACT LINE	---	COUNTY HIGHWAY	---
BLOCK LIMIT (WHERE APPLICABLE)	---	ROADS, STREETS, CHURCHES, ETC.	---
		SECTION CORNERS	2 1/2

**MAP SHEET INDEX**

6	5	4	3	2	1
03	02	01	01	01	01
7	8	9	10	11	12
18	17	16	15	14	13
04	05	06	06	06	06
19	20	21	22	23	24
30	29	28	27	26	25
09	08	07	07	07	07
31	32	33	34	35	36

**TOWNSHIP LOCATOR**

R16W	R15W	R14W	R13W	
T55N	04	03	02	01
T55N	04	03	02	01
T54N	05	06	07	08
T54N	05	06	07	08
T53N	12	11	10	9
T53N	12	11	10	9
T52N	13	14	15	16
T52N	13	14	15	16

**SECTIONS S.E. 1/4 36**  
**TWP. 54 N. RNG. 14 W.**  
**33-07-7-36-4**  
 MAP NUMBER

REVISIONS

DATE	BY	CHANGES OR ADDITIONS